

ALERT-2 Installation: Lismore Rd/Lakewood Rd Intersection

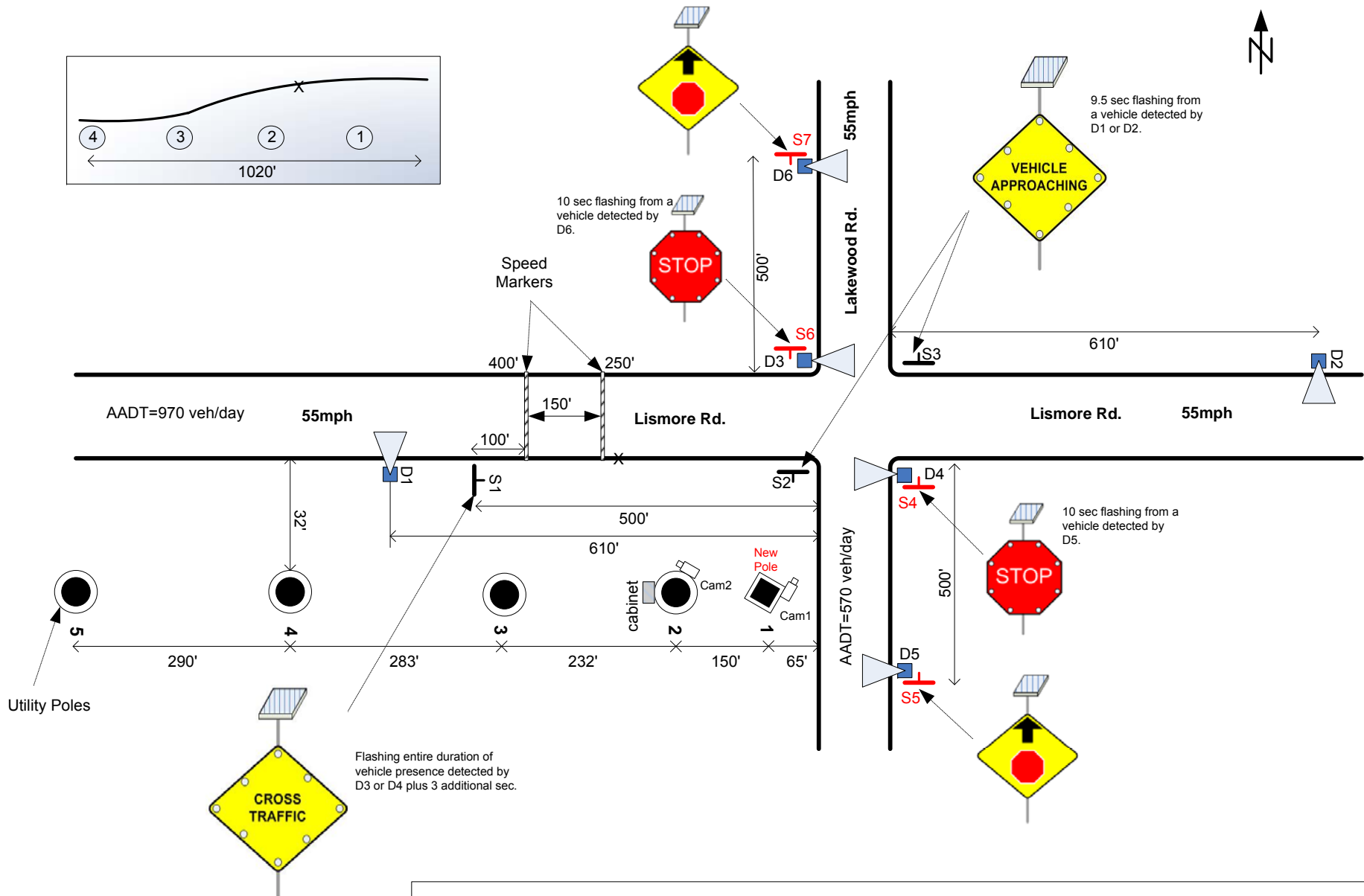

Using the posted speed limit = 55 MPH:

- Minimum advance placement distance for major road warning sign = 320 ft (MN MUTCD Table 2c-4)
- Passenger vehicle time gap (tg) for case B1-left turn from minor road = 7.5 sec (AASHTO Gr Book Table 9-5)
- Intersection Sight Distance (ISD) = $1.47 \cdot V_{\text{major}} \cdot tg = 1.47 \cdot 55 \cdot 7.5 = 606 \text{ ft} \approx 610 \text{ ft}$